

A1 Birtley to Coal House

Scheme Number: TR010031

2.2 Land Plan

APFP Regulation 5(2)(i)
Planning Act 2008
Infrastructure Planning (Applications: Prescribed
Forms and Procedure) Regulations 2009

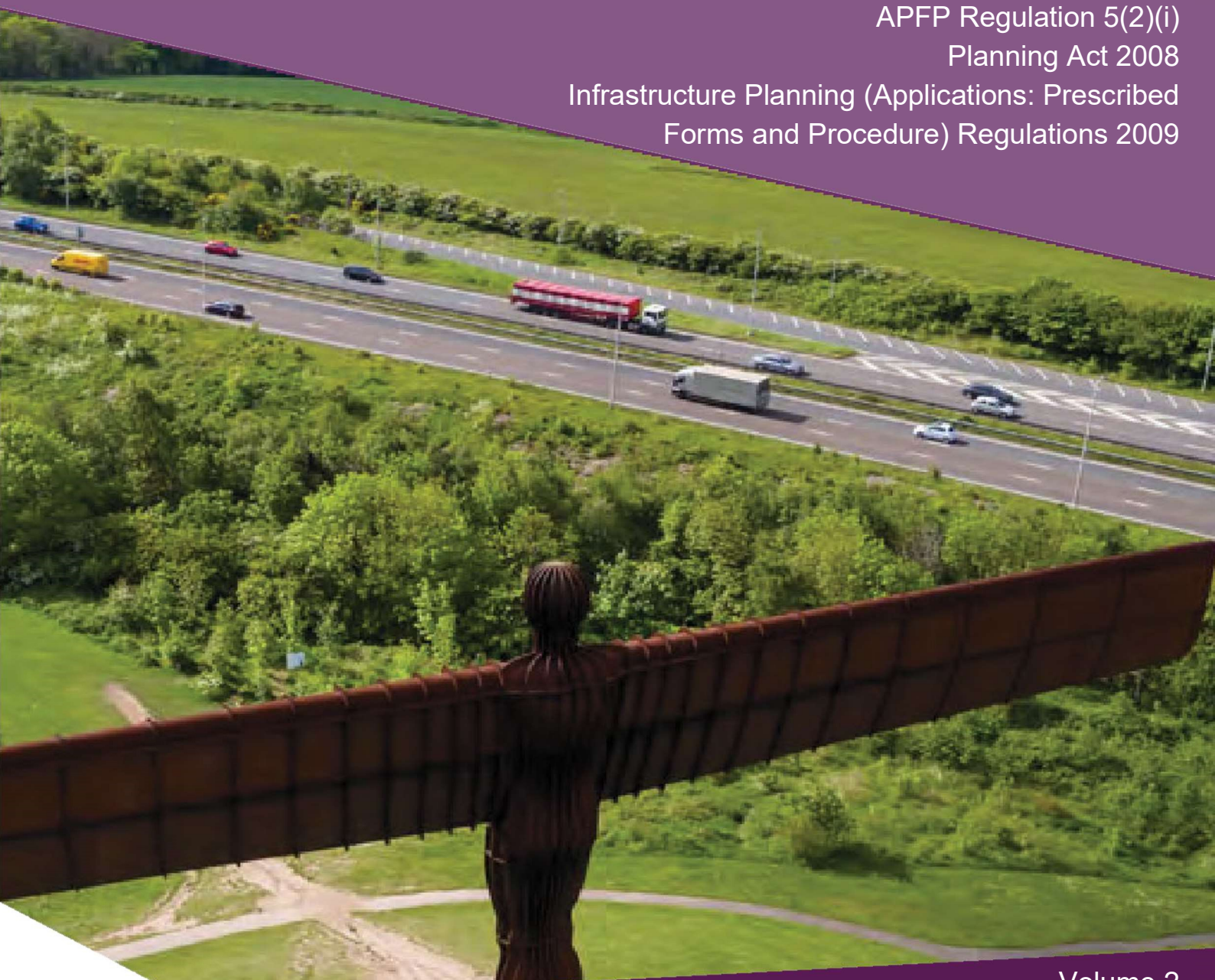

Infrastructure Planning

Planning Act 2008

**The Infrastructure Planning
(Applications: Prescribed Forms and
Procedure - APFP) Regulations 2009**

**The A1 Birtley to Coal House
Development Consent Order 20[xx]**

LAND PLAN

Regulation Reference:	APFP Regulation 5(2)(i)
Planning Inspectorate Scheme Reference	TR010031
Application Document Reference	TR010031/APP/2.2
Author:	A1 Birtley to Coal House Project Team, Highways England

Version	Date	Status of Version
Rev 0	14/08/2019	Application Issue

CONTENTS

1	INTRODUCTION.....	4
1.1	Purpose of this Document.....	4
2	SCHEDULE OF PLANS INCLUDED IN THIS APPLICATION DOCUMENT	5

1 INTRODUCTION

1.1 Purpose of this Document

1.1.1 This Land Plan (this "Plan") relates to an application made by Highways England (the "Applicant") to the Planning Inspectorate (the "Inspectorate") under the Planning Act 2008 (the "2008 Act") for a Development Consent Order (DCO). If made, the DCO would grant consent for the Applicant to undertake the A1 Birtley to Coal House (the "Scheme"). A detailed description of the Scheme can be found in **Chapter 2** of the Environmental Statement (ES) (**Application Document Reference: TR010031/APP/6.1**).

1.1.2 This Plan comprises part of the suite of Application documentation and is included in the Application in compliance with Regulation 5(2)(i), of the Infrastructure Planning (Applications: Prescribed Forms and Procedure) Regulations 2009 (the "2009 Regulations"), which requires:

"5(2)(i) a land plan identifying:-

- (i) the land required for, or affected by, the proposed development;*
- (ii) where applicable, any land over which it is proposed to exercise powers of compulsory acquisition or any right to use land;*
- (iii) any land in relation to which it is proposed to extinguish easements, servitudes and other private rights; and*
- (iv) where the land includes special category land and replacement land, that special category and replacement land."*

1.1.3 This Plan is also being submitted under Regulation 5(4) of the 2009 Regulations which states:

"Where a plan comprises three or more separate sheets a key plan must be provided showing the relationship between the different sheets."

1.1.4 As this Plan is part of the Application documentation, it should be read alongside and is informed by the other Application documents. In particular, the Plan should be read alongside Schedule 1 of the draft DCO (**Application Document Reference: TR010031/APP/3.1**) and the Book of Reference (**Application Document Reference: TR010031/APP/4.3**).

2 SCHEDULE OF PLANS INCLUDED IN THIS APPLICATION DOCUMENT

Document Title	Document Number	Revision
Land Plan - Regulation 5(2)(i) & 5(4) - Key Plan	TR010031/APP/2.2(A)	Rev 0
Land Plan - Regulation 5(2)(i) - Sheet 1 of 5	TR010031/APP/2.2(B)	Rev 0
Land Plan - Regulation 5(2)(i) -Sheet 2 of 5	TR010031/APP/2.2(C)	Rev 0
Land Plan - Regulation 5(2)(i) - Sheet 3 of 5	TR010031/APP/2.2(D)	Rev 0
Land Plan - Regulation 5(2)(i) -Sheet 4 of 5	TR010031/APP/2.2(E)	Rev 0
Land Plan - Regulation 5(2)(i) - Sheet 5 of 5	TR010031/APP/2.2(F)	Rev 0



SHEET 1

JUNCTION 68
LOBLEY HILL

TEAM VALLEY
TRADING ESTATE

GATESHEAD
BOROUGH

JUNCTION 67
COAL HOUSE

SUNDERLAND
BOROUGH

SHEET 2

LAMESLEY

JUNCTION 66
EIGHTON LODGE

SHEET 3

SHEET 4

BIRTLEY

JUNCTION 65
BIRTLEY

SHEET 5

COUNTY DURHAM
UNITARY AUTHORITY

NOTES:

1. All dimensions are in metres unless stated otherwise.
2. These Land Plans should be read in conjunction with other plans and documents in the Development Consent Order application. In particular the Book of Reference (Application Document Reference: TR010031/APP/4.3) and the Statement of Reasons (Application Document Reference: TR010031/APP/4.1).

KEY:

- Local authority boundary

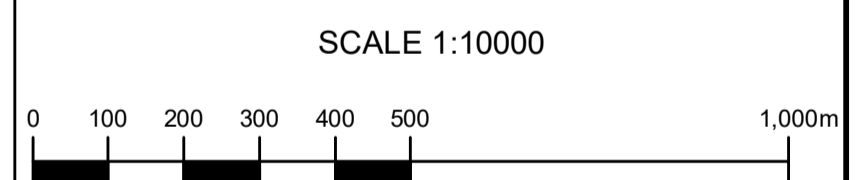

Rev	Date	Description	By	Eng'g Ch'k	Disc' Ch'k	App'd
0	24/07/2019	APPLICATION ISSUE	BS	CVM	SC	NR

Subsidiary: Application Issue Status: S0

PINS Reference Number: TR010031/APP/2.2 (A)



Project Title: A1 Birtley to Coal House

Drawing Title: LAND PLANS
KEY PLAN
REGULATION 5(4)

Scale	Drawn	Checked	Approved	Authorised		
1:10,000	BS	CVM	SC	NR		
Original Size	Date	Date	Date	Date		
A1	24/07/2019	24/07/2019	24/07/2019	24/07/2019		
Drawing Number	Originator	Volume	Revision			
HE551462	WSP	LSI	P0			
ZZ Section	Type	ID	Direction	Type	Role	Number
		X	DR	ZL		26100
						3

JUNCTION 68 - LOBLEY HILL



NOTES:

1. All dimensions are in metres unless stated otherwise.
2. These Land Plans should be read in conjunction with other plans and documents in the Development Consent Order application. In particular the Book of Reference (Application Document Reference: TR010031/APP/4.3) and the Statement of Reasons (Application Document Reference: TR010031/APP/4.1).
3. All easements, servitudes and private rights are proposed to be extinguished on land that is to be acquired unless otherwise stated in the Book of Reference
4. The number labels relate to plot numbers. Please refer to the Book of Reference for more information about these plots, including the approximate area of each plot (in square metres). Plot numbers include a reference to the relevant sheet of the Land Plans. In this numbering convention, a plot number comprises the sheet number followed by a second number that differentiates between different land owners on each plan. The letters which suffix the land owner reference are used to differentiate between plots of the same unique owner on that Land Plan from west to east. e.g: Plot 3/2f, where '3' is the sheet number (sheet 3) and '2f' is the plot number (2f on sheet 3).
5. In plots 5/4b, 5/4d, 5/6, 5/7, 5/8 powers of compulsory acquisition will be restricted to permanent acquisition of rights over subsoil i.e. temporary possession and use of land will not be taken

KEY:

- Order limits
- Permanent acquisition of land
- Temporary possession and use of land
- Permanent acquisition of rights over land
- Acquisition of land except for highway/railway beneath soffit level of bridge
- Acquisition of land above ground level and temporary possession and use of land at ground level
- Permanent acquisition of rights over subsoil including temporary possession and use of land
- Local authority boundary

SCALE 1:2500

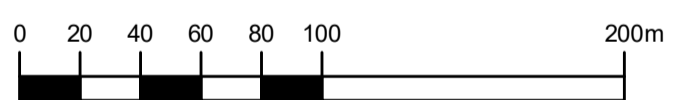

Rev	Date	Description	By	Eng'g Ch'k	Disc' Ch'k	App'd
0	24/07/2019	APPLICATION ISSUE	BS	CVM	SC	NR

Application Issue S0

PINS Reference Number TR010031/APP/2.2 (B)

Client

Project Title A1 Birtley to Coal House

Drawing Title LAND PLANS
SHEET 1 OF 5
REGULATION 5(2)(i)

Scale	Drawn	Checked	Approved	Authorised
1:2,500	BS	CVM	SC	NR

Original Size	Date	Date	Date	Date
A1	24/07/2019	24/07/2019	24/07/2019	24/07/2019

Drawing Number	Originator	Volume	Revision
HE551462	WSP	LSI	P0

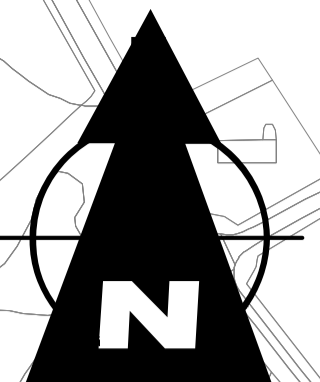

NOTES:

1. All dimensions are in metres unless stated otherwise.
2. These Land Plans should be read in conjunction with other plans and documents in the Development Consent Order application. In particular the Book of Reference (Application Document Reference: TR010031/APP/4.3) and the Statement of Reasons (Application Document Reference: TR010031/APP/4.1).
3. All easements, servitudes and private rights are proposed to be extinguished on land that is to be acquired unless otherwise stated in the Book of Reference.
4. The number labels relate to plot numbers. Please refer to the Book of Reference for more information about these plots, including the approximate area of each plot (in square metres). Plot numbers include a reference to the relevant sheet of the Land Plans. In this numbering convention, a plot number comprises the sheet number followed by a second number that differentiates between different land owners on each plan. The letters which suffix the land owner reference are used to differentiate between plots of the same unique owner on that Land Plan from west to east. e.g: Plot 3/2f, where '3' is the sheet number (sheet 3) and '2f' is the plot number (2f on sheet 3).
5. In plots 5/4b, 5/4d, 5/6, 5/7, 5/8 powers of compulsory acquisition will be restricted to permanent acquisition of rights over subsoil i.e. temporary possession and use of land will not be taken.

KEY:

- Order limits
- Permanent acquisition of land
- Temporary possession and use of land
- Permanent acquisition of rights over land
- Acquisition of land except for highway/railway beneath soffit level of bridge
- Acquisition of land above ground level and temporary possession and use of land at ground level
- Permanent acquisition of rights over subsoil including temporary possession and use of land
- Local authority boundary

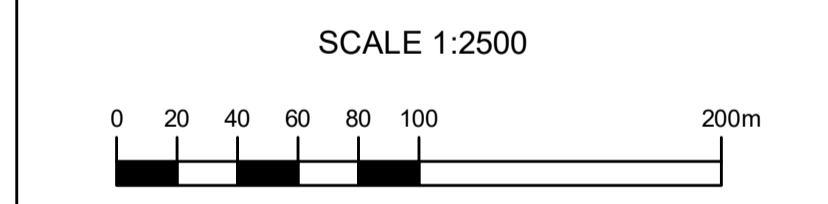

Rev	Date	Description	By	Eng'g Ch'k	Disc' Ch'k	App'd
0	24/07/2019	APPLICATION ISSUE	BS	CVM	SC	NR

Application Issue S0

PINS Reference Number: TR010031/APP/2.2 (C)



Project Title: A1 Birtley to Coal House

Drawing Title: LAND PLANS SHEET 2 OF 5 REGULATION 5(2)(i)

Scale	1:2,500	Drawn	BS	Checked	CVM	Approved	SC	Authorised	NR
-------	---------	-------	----	---------	-----	----------	----	------------	----

Original Site	A1	Date	24/07/2019	Date	24/07/2019	Date	24/07/2019	Date	24/07/2019
---------------	----	------	------------	------	------------	------	------------	------	------------

Drawing Number	HE551462	Originator	WSP	Volume	LSI	Revision	P0
----------------	----------	------------	-----	--------	-----	----------	----

ZZ	Section	Type	ID	Direction	Type	Role	Number
				X	DR	ZL	26102

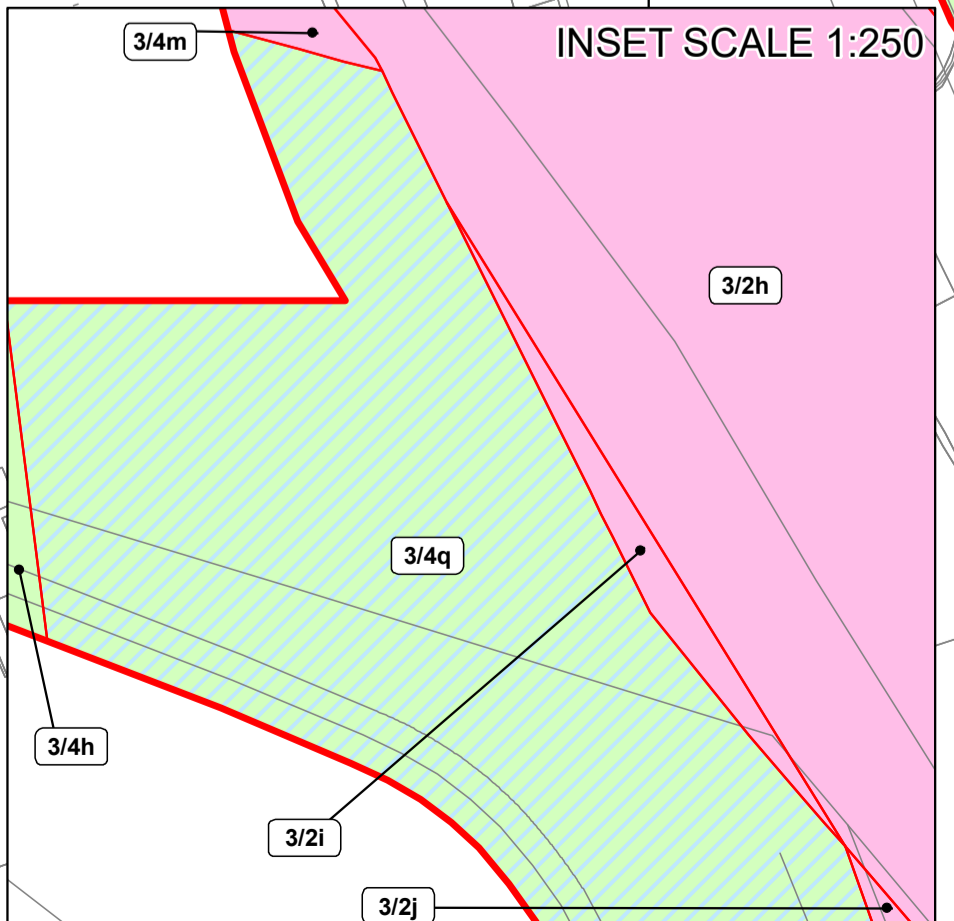
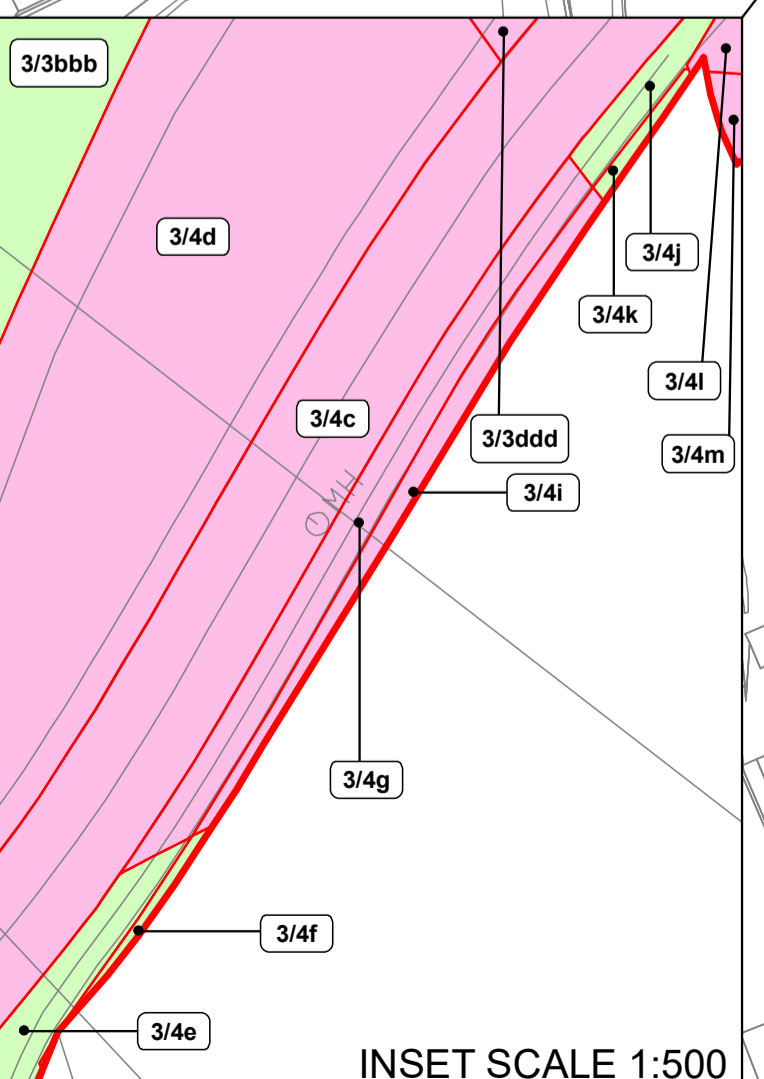
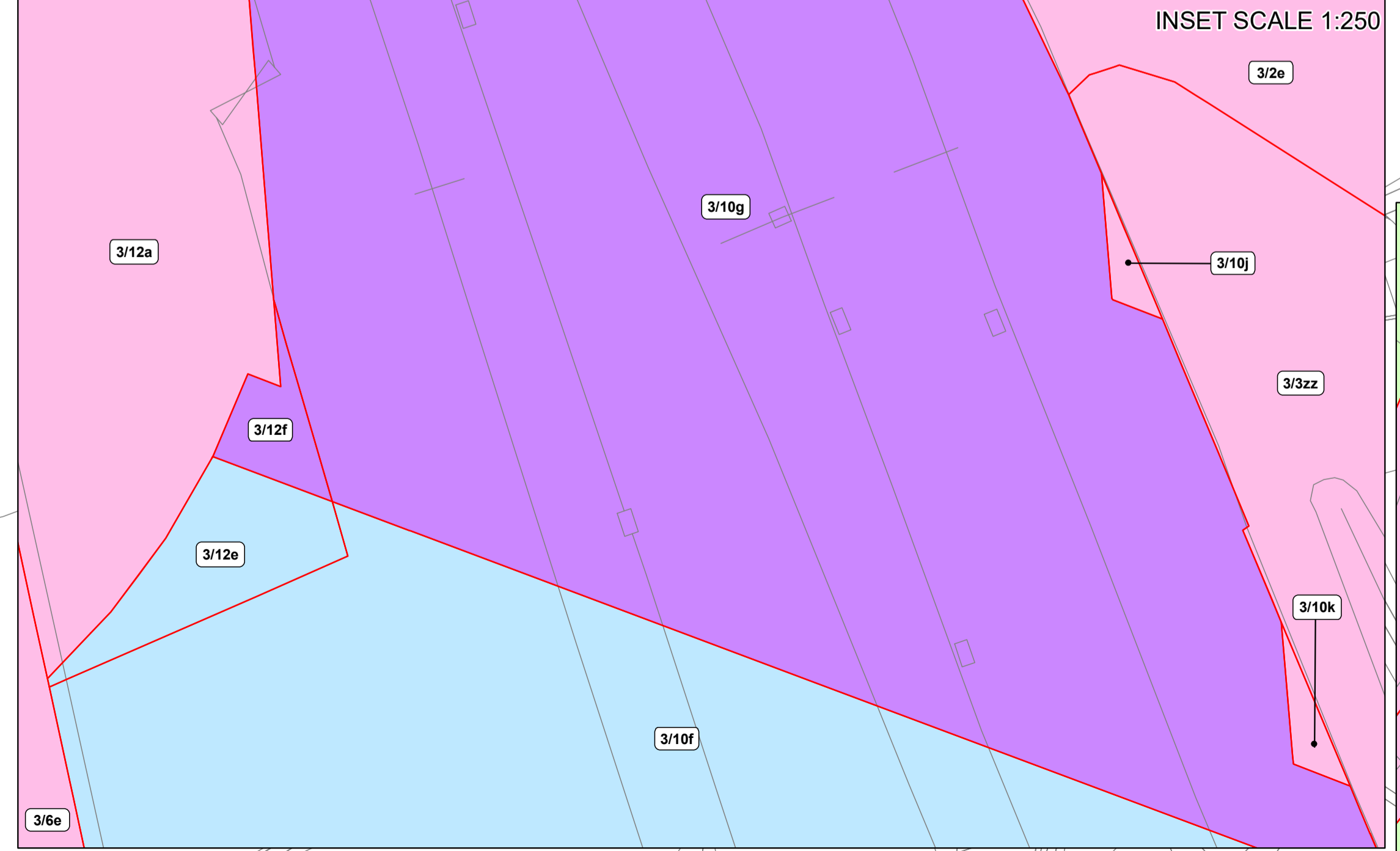
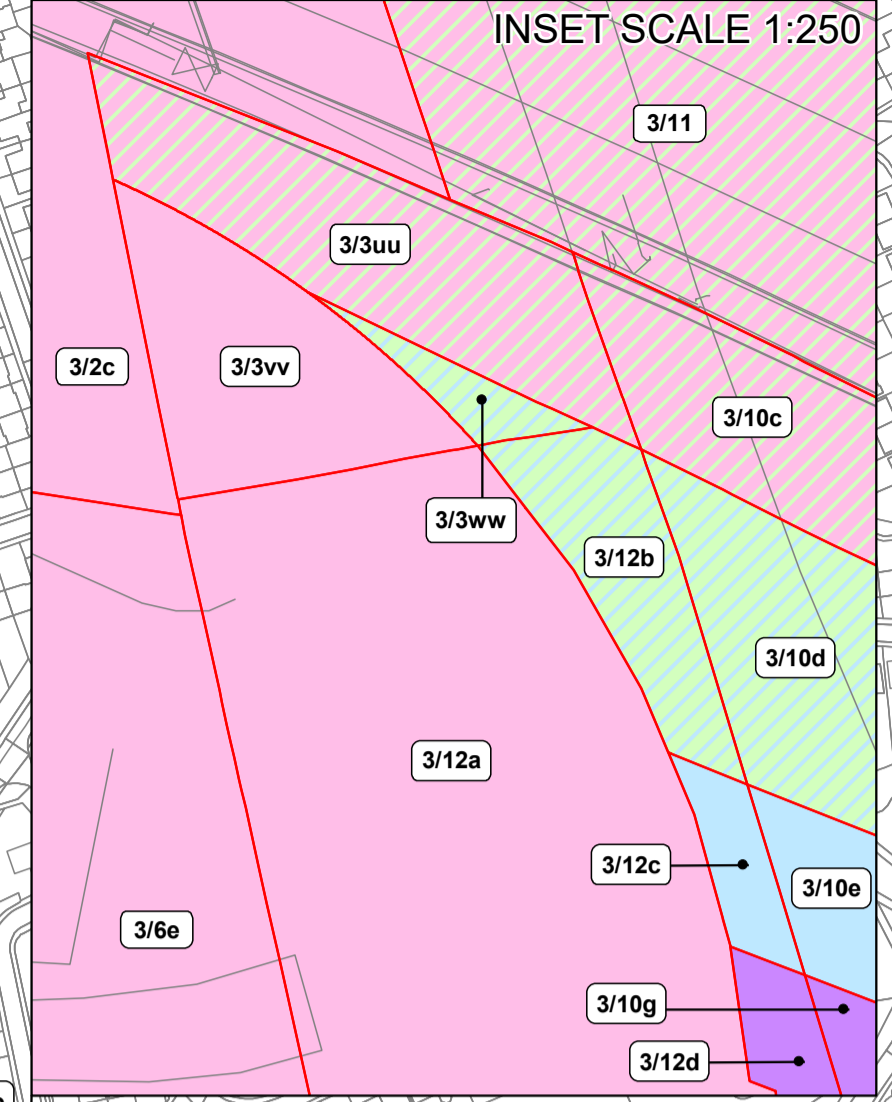
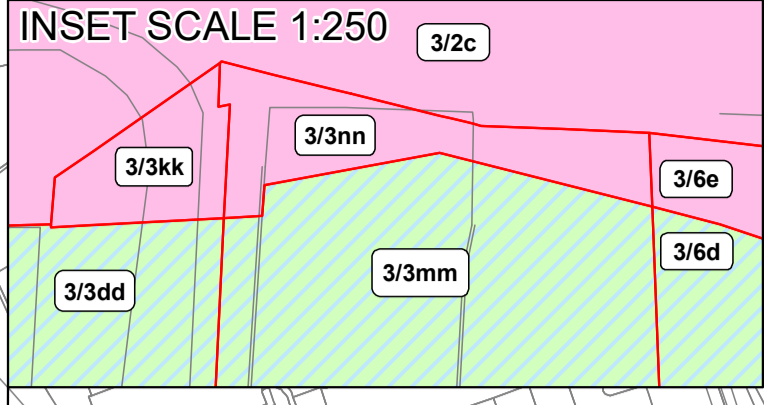
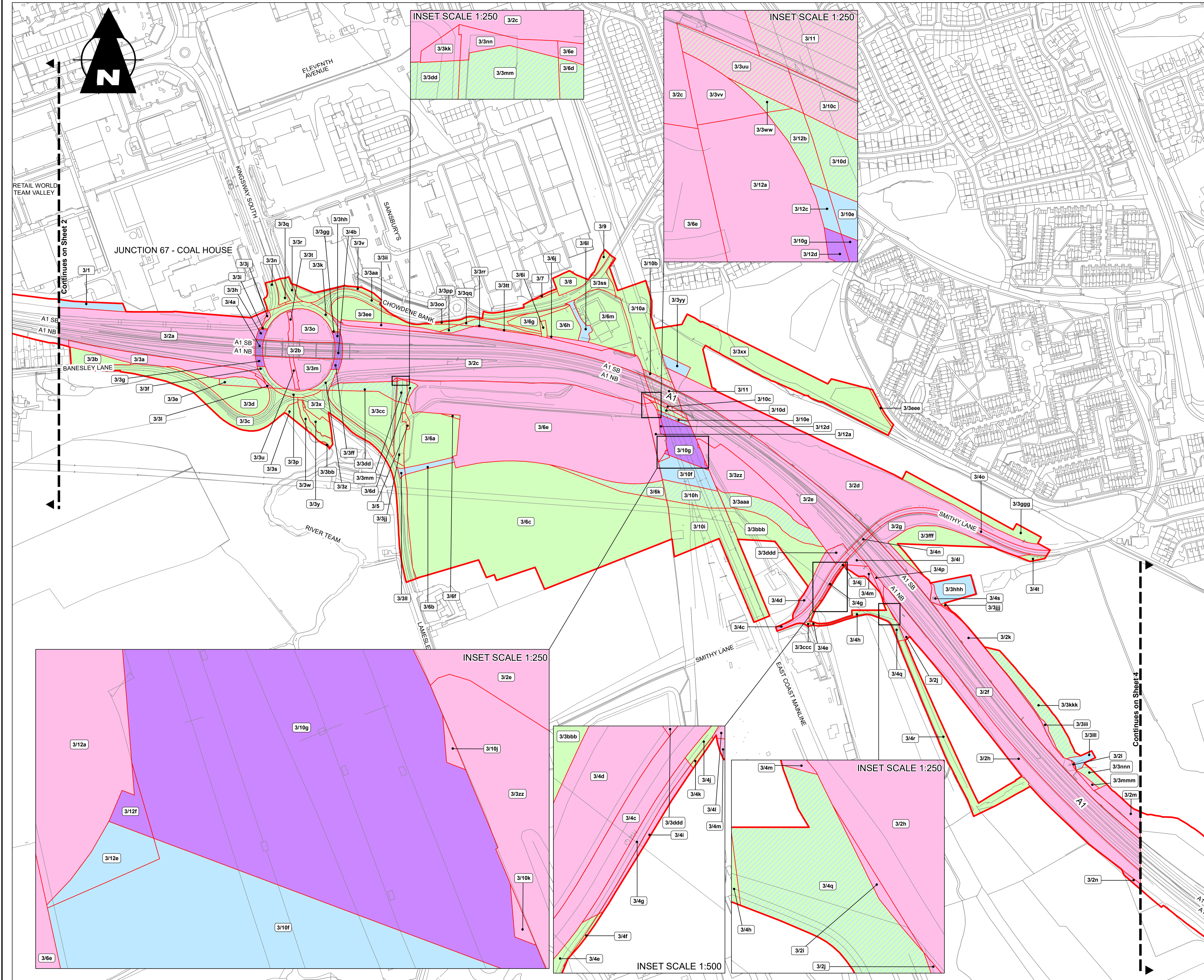

NOTES:

1. All dimensions are in metres unless stated otherwise.
2. These Land Plans should be read in conjunction with other plans and documents in the Development Consent Order application. In particular the Book of Reference (Application Document Reference: TR010031/APP/4.3) and the Statement of Reasons (Application Document Reference: TR010031/APP/4.1).
3. All easements, servitudes and private rights are proposed to be extinguished on land that is to be acquired unless otherwise stated in the Book of Reference.
4. The number labels relate to plot numbers. Please refer to the Book of Reference for more information about these plots, including the approximate area of each plot (in square metres). Plot numbers include a reference to the relevant sheet of the Land Plans. In this numbering convention, a plot number comprises the sheet number followed by a second number that differentiates between different land owners on each plan. The letters which suffix the land owner reference are used to differentiate between plots of the same unique owner on that Land Plan from west to east, e.g. Plot 3/2f, where '3' is the sheet number (sheet 3) and '2f' is the plot number (2f on sheet 3).
5. In plots 5/4b, 5/4d, 5/6, 5/7, 5/8 powers of compulsory acquisition will be restricted to permanent acquisition of rights over subsoil i.e. temporary possession and use of land will not be taken.

KEY:

- Order limits
- Permanent acquisition of land
- Temporary possession and use of land
- Permanent acquisition of rights over land
- Acquisition of land except for highway/railway beneath soffit level of bridge
- Acquisition of land above ground level and temporary possession and use of land at ground level
- Permanent acquisition of rights over subsoil including temporary possession and use of land
- Local authority boundary

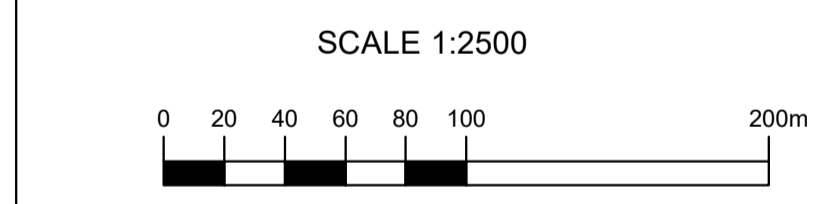

Rev	Date	Description	By	Eng' Chk	Disc' Chk	App'd
0	24/07/2019	APPLICATION ISSUE	BS	CVM	SC	NR

Application Issue S0

PINS Reference Number: TR010031/APP/2.2 (D)

Client:

Project Title: A1 Birtley to Coal House

Drawing Title: LAND PLANS SHEET 3 OF 5 REGULATION 5(2)(i)

Scale	Drawn	Checked	Approved	Authorised
1:2,500	BS	CVM	SC	NR

Original Size	Date	Date	Date	Date
A1	24/07/2019	24/07/2019	24/07/2019	24/07/2019

Drawing Number: HE551462 | Originator: WSP | Volume: LSI | Revision: P0
 ZZ Section: X | Direction: DR | Rate: ZL | Number: 26103 | PW Stage Code: 3

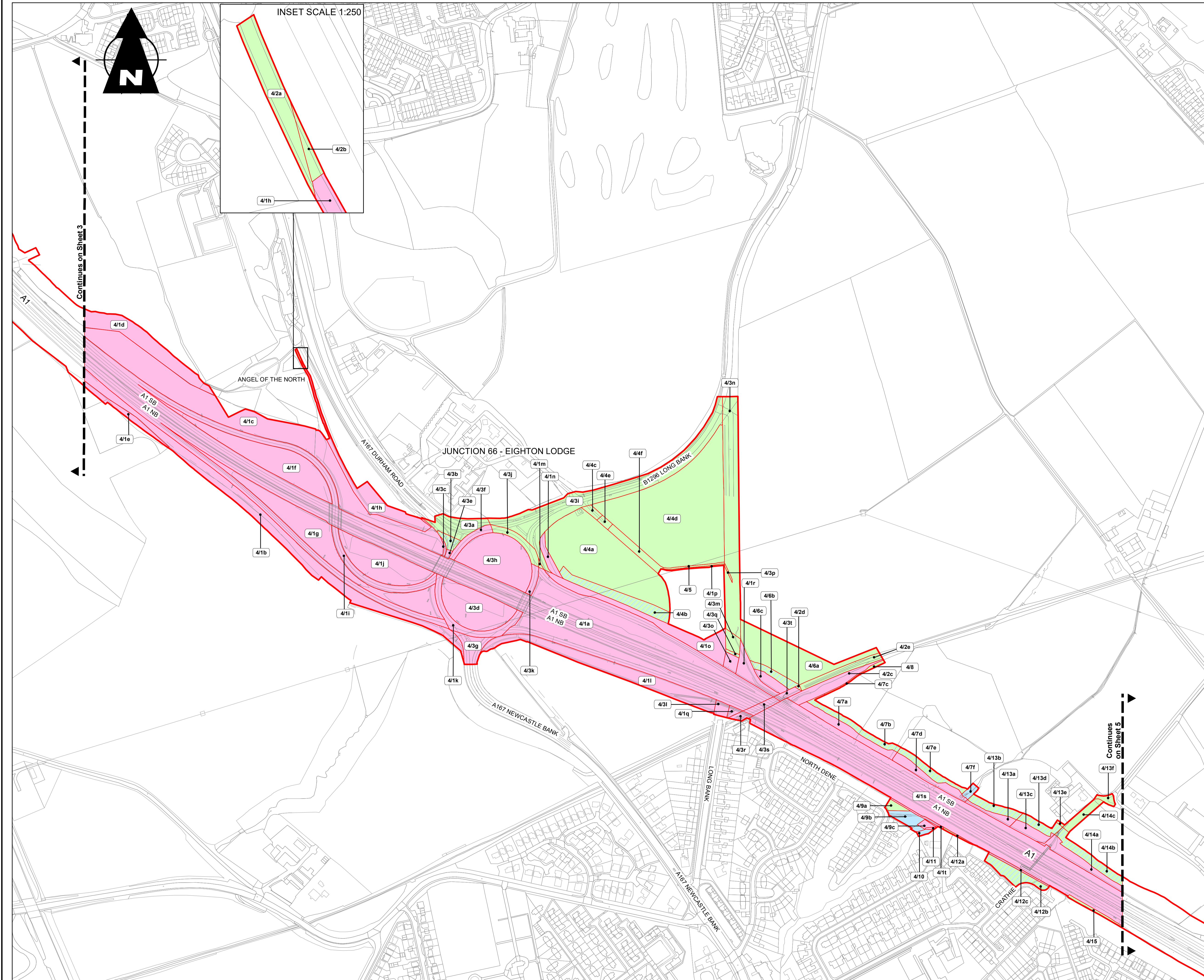

- NOTES:**
- All dimensions are in metres unless stated otherwise.
 - These Land Plans should be read in conjunction with other plans and documents in the Development Consent Order application. In particular the Book of Reference (Application Document Reference: TR010031/APP/4.3) and the Statement of Reasons (Application Document Reference: TR010031/APP/4.1).
 - All easements, servitudes and private rights are proposed to be extinguished on land that is to be acquired unless otherwise stated in the Book of Reference.
 - The number labels relate to plot numbers. Please refer to the Book of Reference for more information about these plots, including the approximate area of each plot (in square metres). Plot numbers include a reference to the relevant sheet of the Land Plans. In this numbering convention, a plot number comprises the sheet number followed by a second number that differentiates between different land owners on each plan. The letters which suffix the land owner reference are used to differentiate between plots of the same unique owner on that Land Plan from west to east. e.g: Plot 3/2f, where '3' is the sheet number (sheet 3) and '2f' is the plot number (2f on sheet 3).
 - In plots 5/4b, 5/4d, 5/6, 5/7, 5/8 powers of compulsory acquisition will be restricted to permanent acquisition of rights over subsoil i.e. temporary possession and use of land will not be taken.

- KEY:**
- Order limits
 - Permanent acquisition of land
 - Temporary possession and use of land
 - Permanent acquisition of rights over land
 - Acquisition of land except for highway/railway beneath soffit level of bridge
 - Acquisition of land above ground level and temporary possession and use of land at ground level
 - Permanent acquisition of rights over subsoil including temporary possession and use of land
 - Local authority boundary

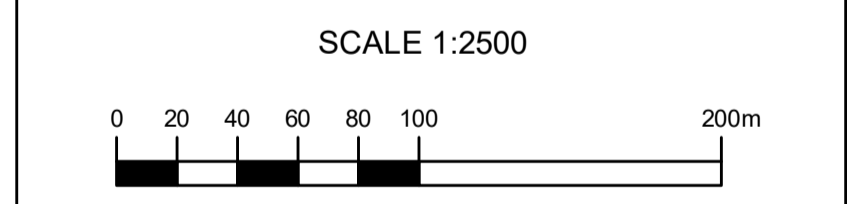

0		24/07/2019	APPLICATION ISSUE	BS	CVM	SC	NR
Rev	Date	Description	By	Eng'g Ch'k	Disc' Ch'k	App'd	
Application Issue							S0
PINS Reference Number TR010031/APP/2.2 (E)							
Client 							
Project Title A1 Birtley to Coal House							
Drawing Title LAND PLANS SHEET 4 OF 5 REGULATION 5(2)(i)							
Scale	1:2,500	Drawn	BS	Checked	CVM	Approved	SC
Original Size	A1	Date	24/07/2019	Date	24/07/2019	Date	24/07/2019
Drawing Number	HE551462	Originator	WSP	Volume	LSI	Revision	P0
ZZ	Section	Type	ID	Direction	Type	Role	Number
				X	DR	ZL	26104
HE551462-WSP-LSI-ZZ-X-DR-ZL-26104							3

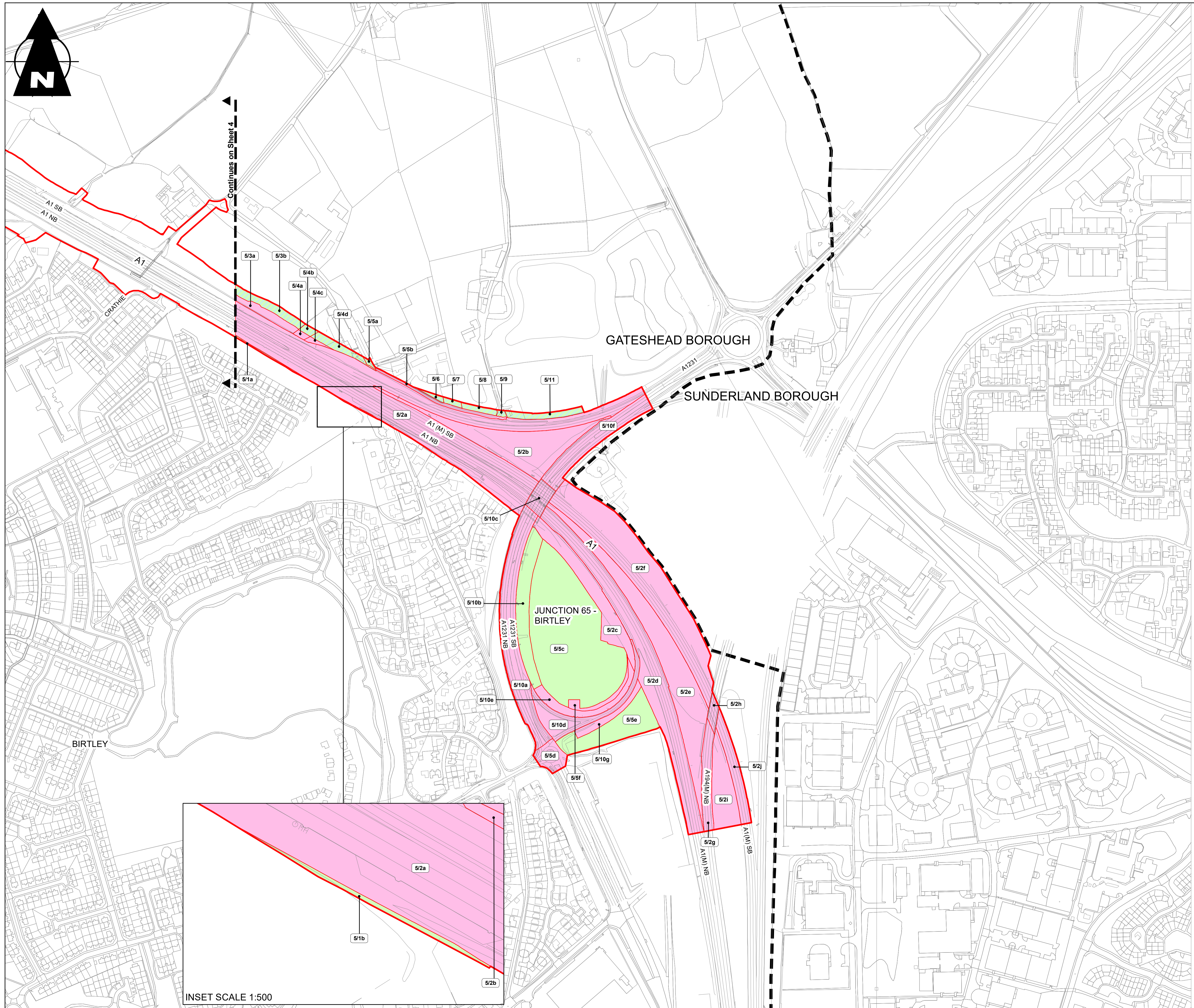

NOTES:

1. All dimensions are in metres unless stated otherwise.
2. These Land Plans should be read in conjunction with other plans and documents in the Development Consent Order application. In particular the Book of Reference (Application Document Reference: TR010031/APP/4.3) and the Statement of Reasons (Application Document Reference: TR010031/APP/4.1).
3. All easements, servitudes and private rights are proposed to be extinguished on land that is to be acquired unless otherwise stated in the Book of Reference.
4. The number labels relate to plot numbers. Please refer to the Book of Reference for more information about these plots, including the approximate area of each plot (in square metres). Plot numbers include a reference to the relevant sheet of the Land Plans. In this numbering convention, a plot number comprises the sheet number followed by a second number that differentiates between different land owners on each plan. The letters which suffix the land owner reference are used to differentiate between plots of the same unique owner on that Land Plan from west to east. e.g: Plot 3/2f, where '3' is the sheet number (sheet 3) and '2f' is the plot number (2f on sheet 3).
5. In plots 5/4b, 5/4d, 5/6, 5/7, 5/8 powers of compulsory acquisition will be restricted to permanent acquisition of rights over subsoil i.e. temporary possession and use of land will not be taken.

KEY:

- Order limits
- Permanent acquisition of land
- Temporary possession and use of land
- Permanent acquisition of rights over land
- Acquisition of land except for highway/railway beneath soffit level of bridge
- Acquisition of land above ground level and temporary possession and use of land at ground level
- Permanent acquisition of rights over subsoil including temporary possession and use of land
- Local authority boundary

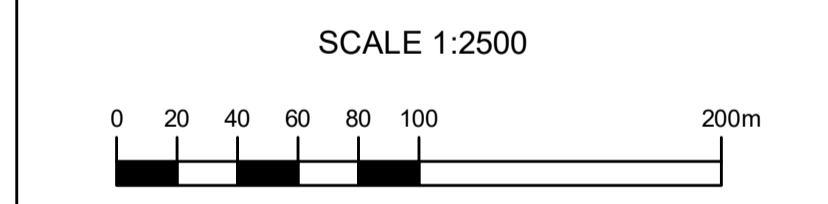

Rev	Date	Description	By	Eng'g Ch'k	Disc' Ch'k	App'd
0	24/07/2019	APPLICATION ISSUE	BS	CVM	SC	NR

Application Issue S0

PINS Reference Number: TR010031/APP/2.2 (F)

Client:

Project Title: A1 Birtley to Coal House

Drawing Title: LAND PLANS SHEET 5 OF 5 REGULATION 5(2)(i)

Scale	Drawn	Checked	Approved	Authorised
1:2,500	BS	CVM	SC	NR
Original Size	Date	Date	Date	Date
A1	24/07/2019	24/07/2019	24/07/2019	24/07/2019
Drawing Number	Originator	Volume	Revision	
HE551462	WSP	LSI	P0	
ZZ	X	DR	ZL	26105
Section	Type	ID	Direction	Role
				Number
				3